

LIVE YOUR TRUE NORTH

PANAMA CANAL-VIEW RESIDENCES IN THE VIBRANT AMADOR



Nautilus

AT THE PANAMA CANAL

8 °56'22.8"N

79 °33'15.4"W

A M A D O R



Nautilus

AT THE PANAMA CANAL

*images for illustrative purposes

An aerial, high-angle photograph of the Panama Canal. Several large cargo ships are visible, moving through the waterway. The canal is flanked by dark, forested hills. The sky is filled with dramatic, dark clouds, with a bright light source (likely the sun) breaking through near the horizon, creating a strong reflection on the water. The overall mood is majestic and powerful.

THE BEAUTY OF THE ENCOUNTER

Nautilus

AT THE PANAMA CANAL



THE WONDER



THE ADVENTURE



THE LOCATION

BRIDGE OF
THE AMERICAS

PANAMA
CITY

Nautilus

AT THE PANAMA CANAL



PANAMA CANAL

BIOMUSEUM

AMADOR
CAUSEWAY

AMADOR
ISLANDS

Amador is the vibrant heart guarding the entrance to the Panama Canal, showcasing the beauty of landscapes formed where the Pacific meets the Atlantic.

As Panama's most important marine connection point, Amador hosts cruise ship visits and is a destination for marinas, allowing quick access to Panama's main islands.

Amador is a tourist gem with spectacular views and diverse marine life. With its mix of restaurants, prestigious shops, and outdoor activities, it's the perfect destination for those seeking luxury, entertainment, and unique seaside experiences.

A M A D O R



CANAL-VIEW RESIDENCES IN THE VIBRANT AMADOR



AT THE PANAMA CANAL

Nautilus

*images for illustrative purposes



WHERE THE COMPASS POINTS HOME

AMENITIES

| BEACH CLUB

| OCEAN FRONT RESTAURANT

| SPA

| ROOFTOP POOL

| ROOFTOP BAR & LOUNGE

| VALET PARKING

| CO-WORKING

| GAME ROOM

| CONCIERGE 24/7

| FITNESS ROOM

Located in the exclusive Amador area, Nautilus arrives to redefine the concept of luxury and splendor. A project for all those who seek a unique lifestyle. Enjoy a privileged location with incredible views of the Panama Canal.



Nautilus has an exclusive Beach Club on the ground floor of the project, a star amenity that guarantees the ideal environment to connect with the serenity of the ocean.

Discover the future of coastal living at Nautilus, where every detail is designed to offer unique experiences; an investment in your quality of life.



1 BEDROOM CORNER RESIDENCE

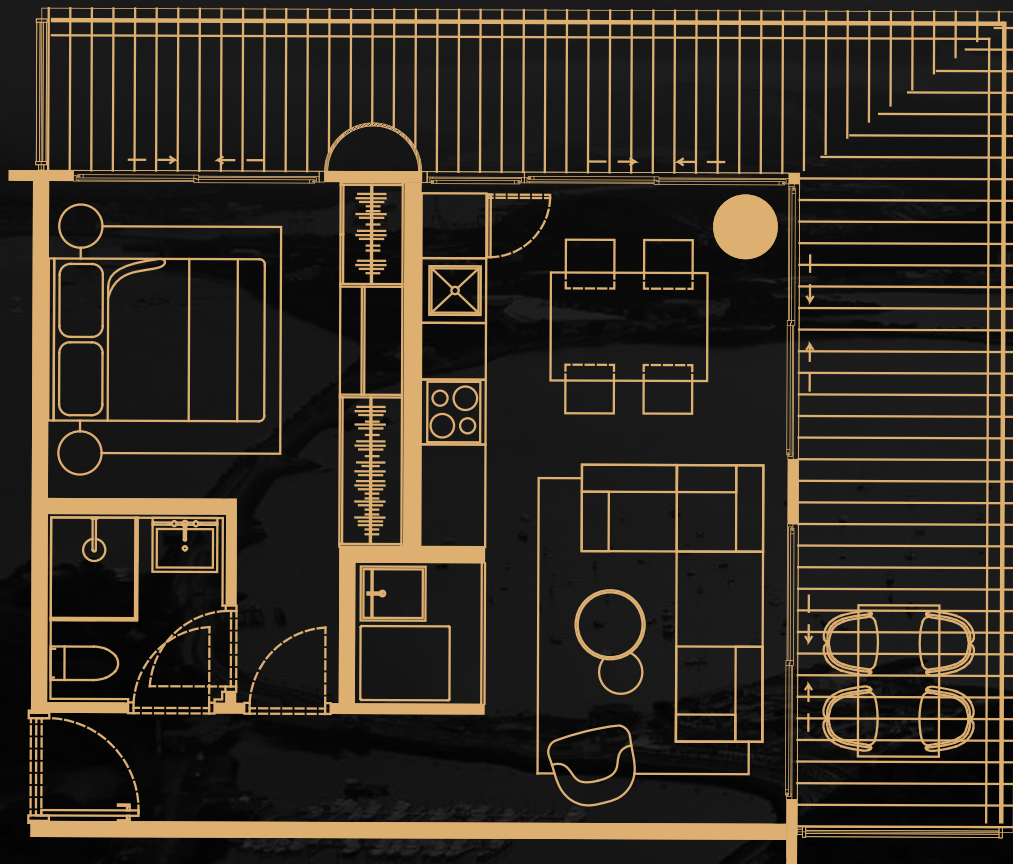

MODEL A

68.67m²

1 bedroom

LATERAL CANAL VIEW

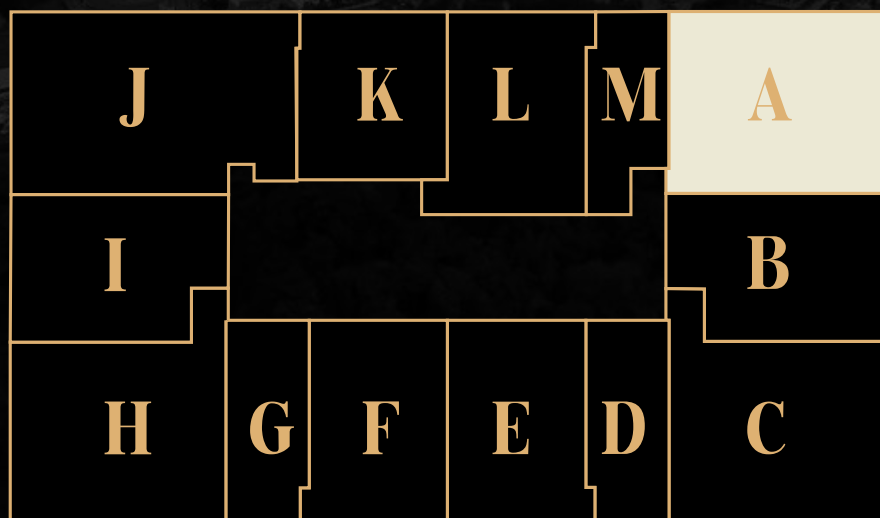

CITY/ OCEAN VIEW

CANAL VIEW

CANAL/ BRIDGE VIEW

1 BEDROOM RESIDENCE



MODELS I & B
52.57m²
1 bedroom

LATERAL CANAL VIEW

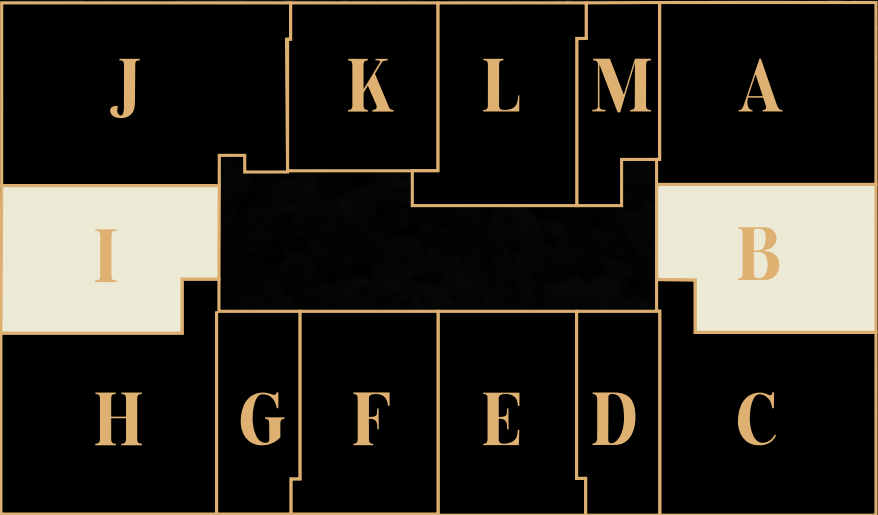

CITY/ OCEAN VIEW

CANAL VIEW

CANAL/ BRIDGE VIEW

1 BEDROOM CORNER RESIDENCE

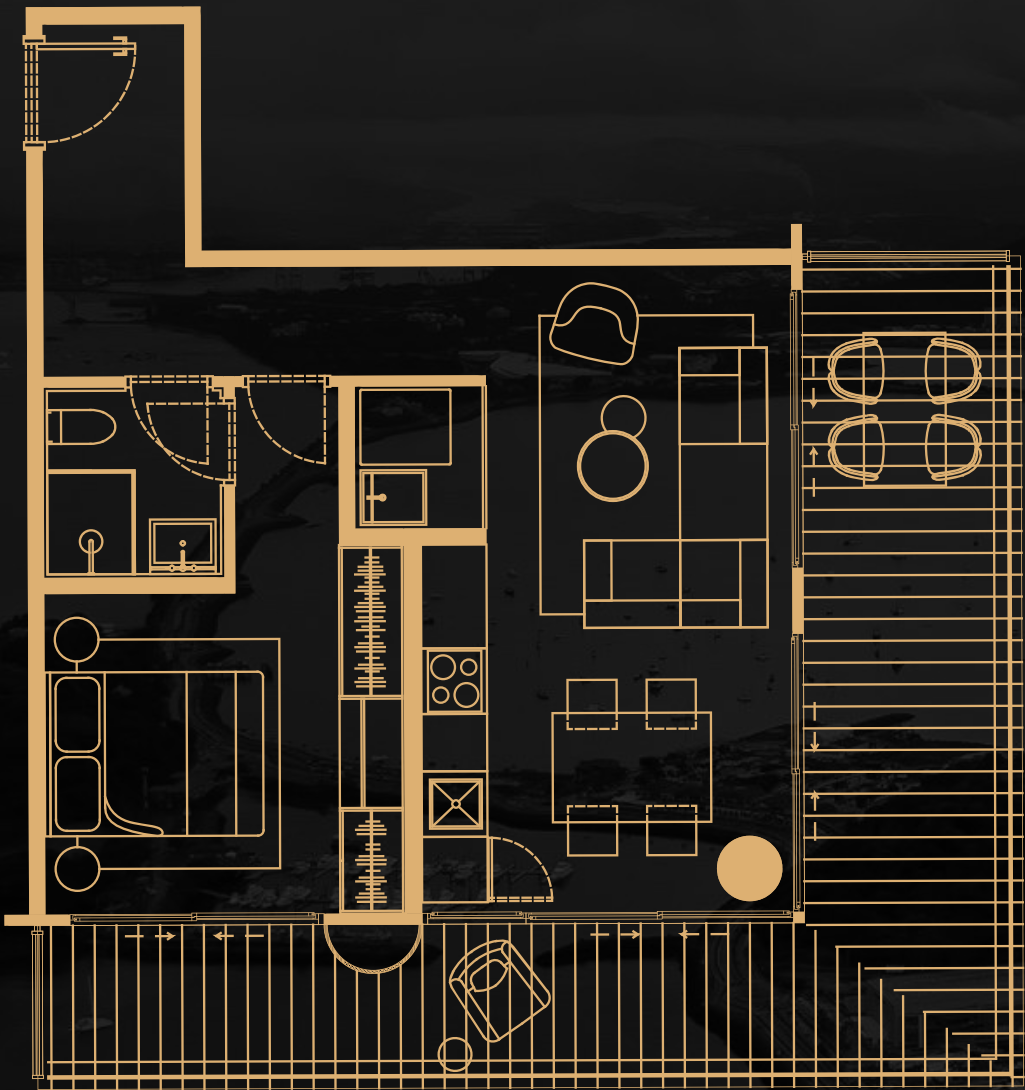

MODELS C & H
71.92m²
1 bedroom

LATERAL CANAL VIEW

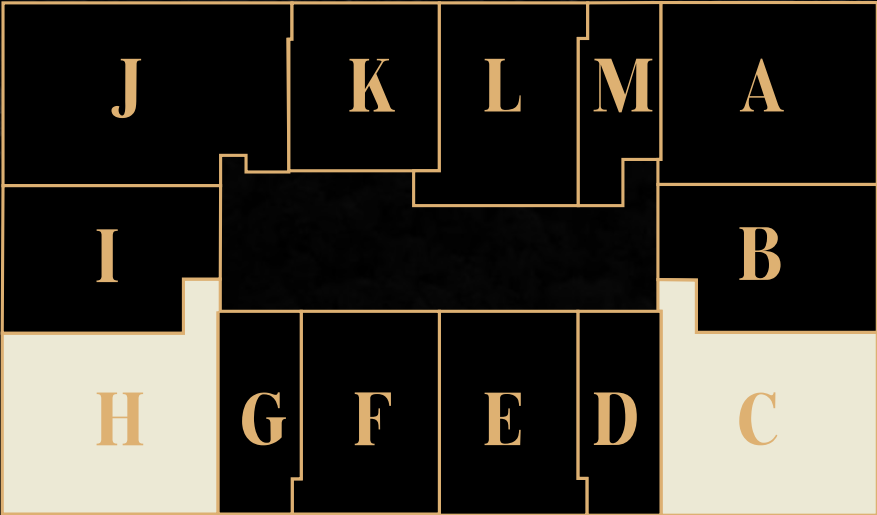

CITY/ OCEAN VIEW

CANAL VIEW

CANAL/ BRIDGE VIEW

STUDIO RESIDENCE

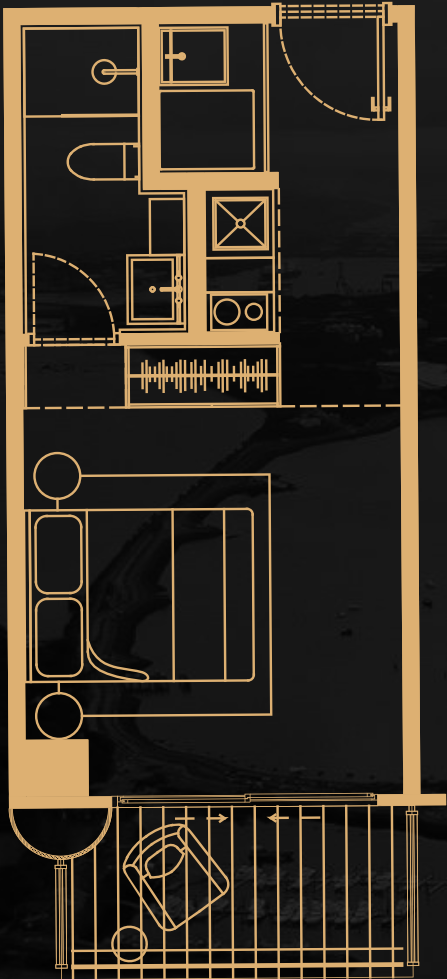

MODELS D & G
28.76m²
Studio

LATERAL CANAL VIEW

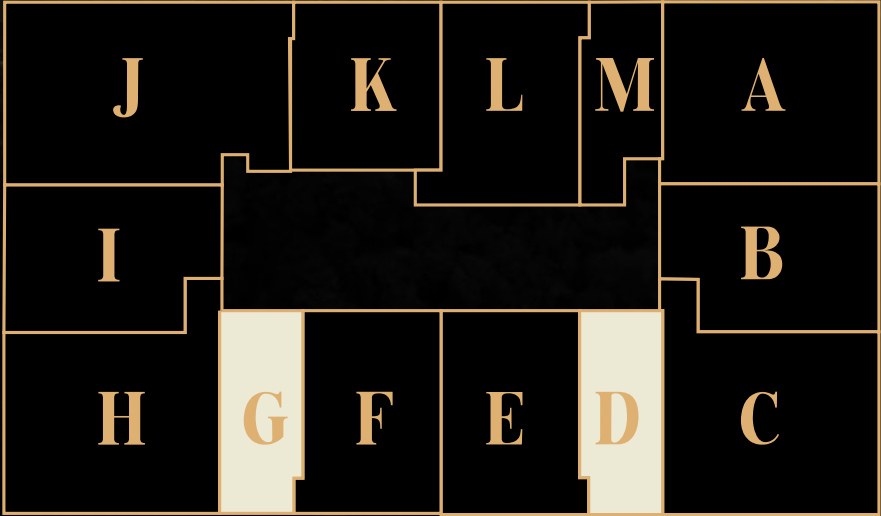

CITY/ OCEAN VIEW

CANAL VIEW

CANAL/ BRIDGE VIEW

1 BEDROOM RESIDENCE

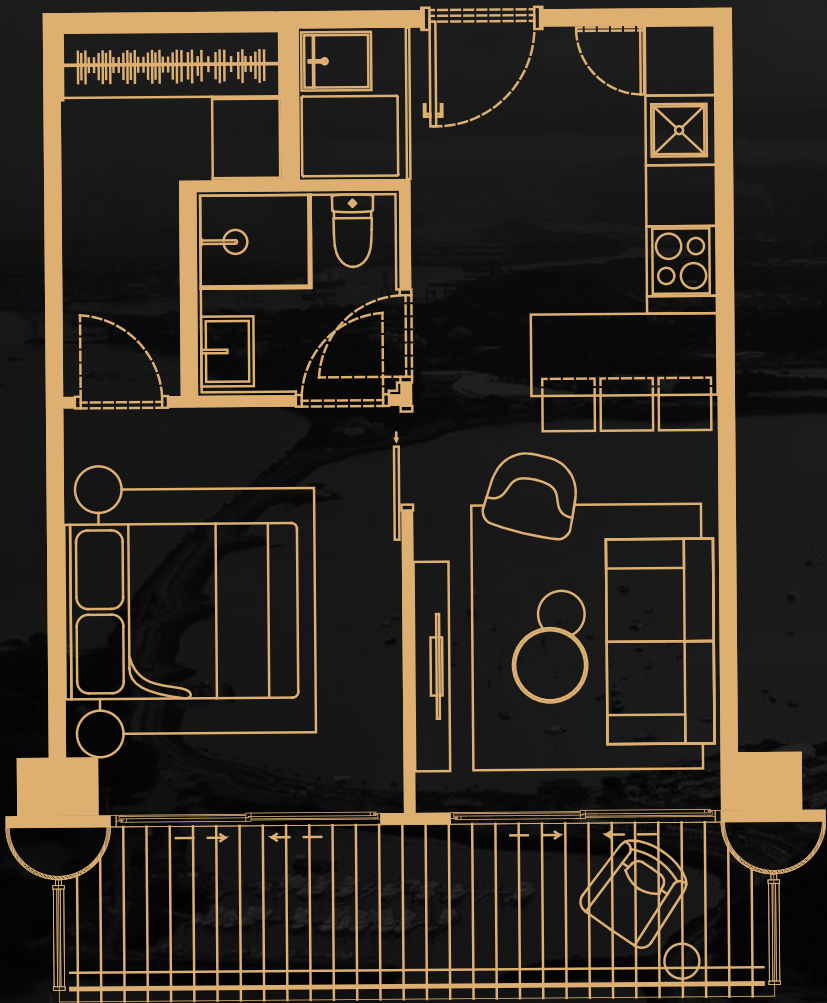

MODELS E & F
49.65m²
1 bedroom

LATERAL CANAL VIEW

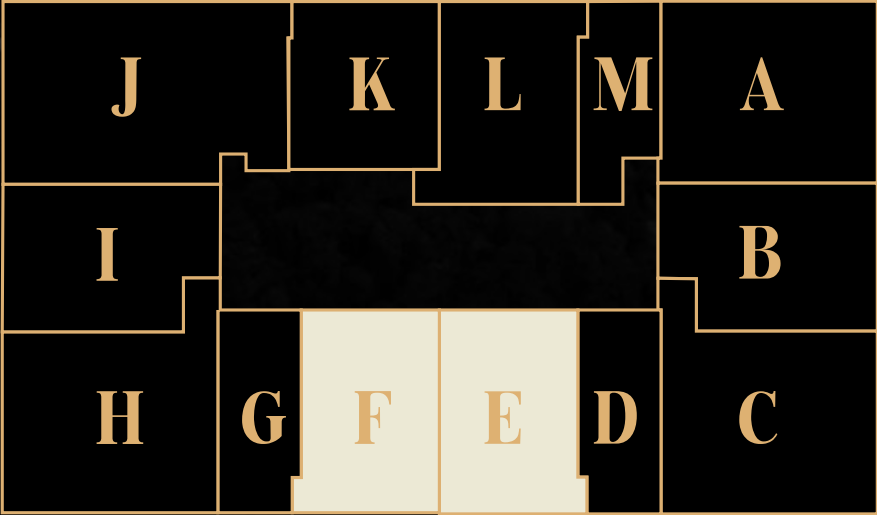

CITY/ OCEAN VIEW

CANAL VIEW

CANAL/ BRIDGE VIEW

2 BEDROOMS RESIDENCE

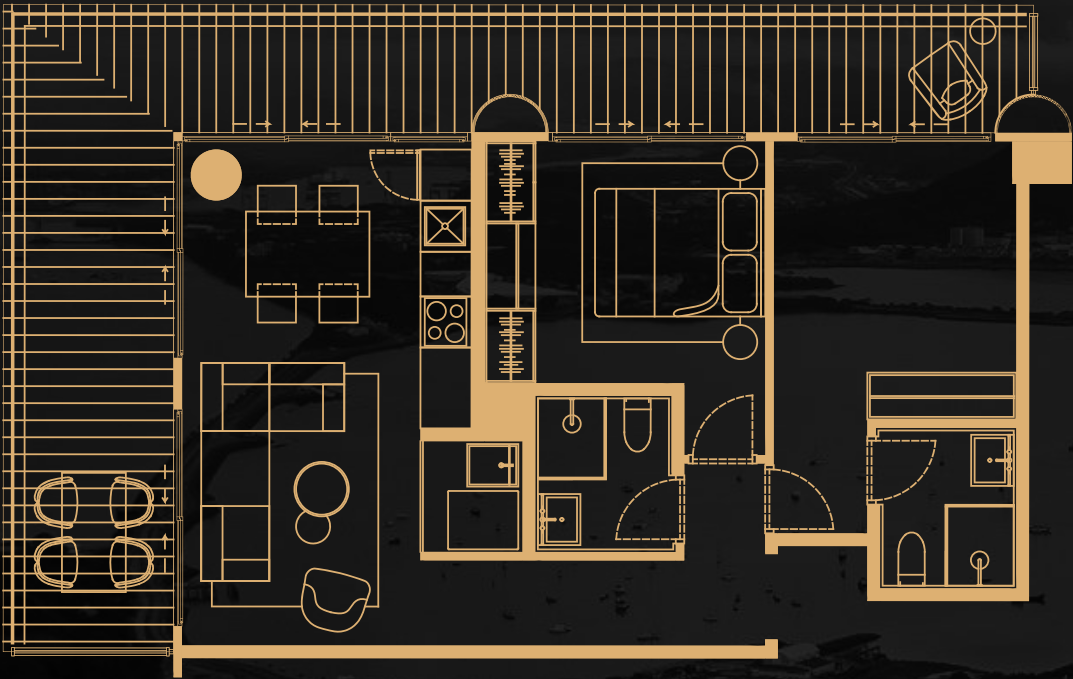

MODEL J
88.79m²
2 bedrooms

LATERAL CANAL VIEW

CITY/ OCEAN VIEW

CANAL VIEW

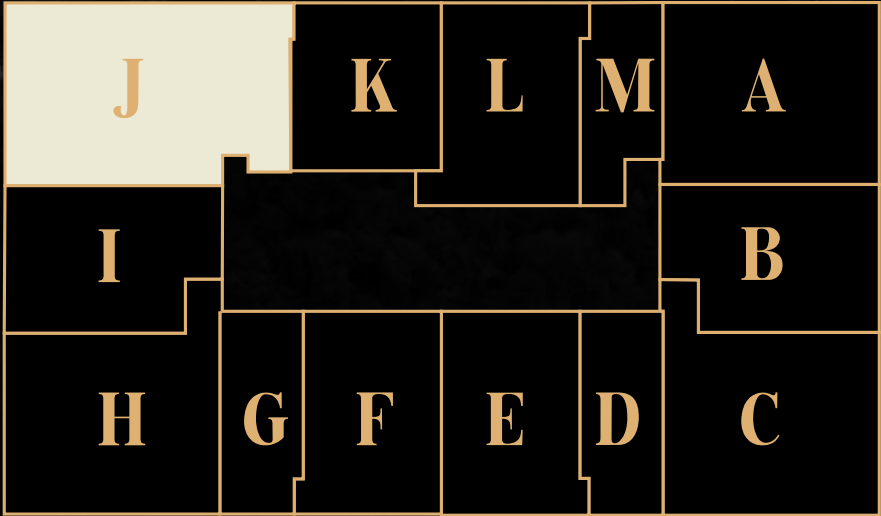

CANAL/ BRIDGE VIEW

1 BEDROOM RESIDENCE

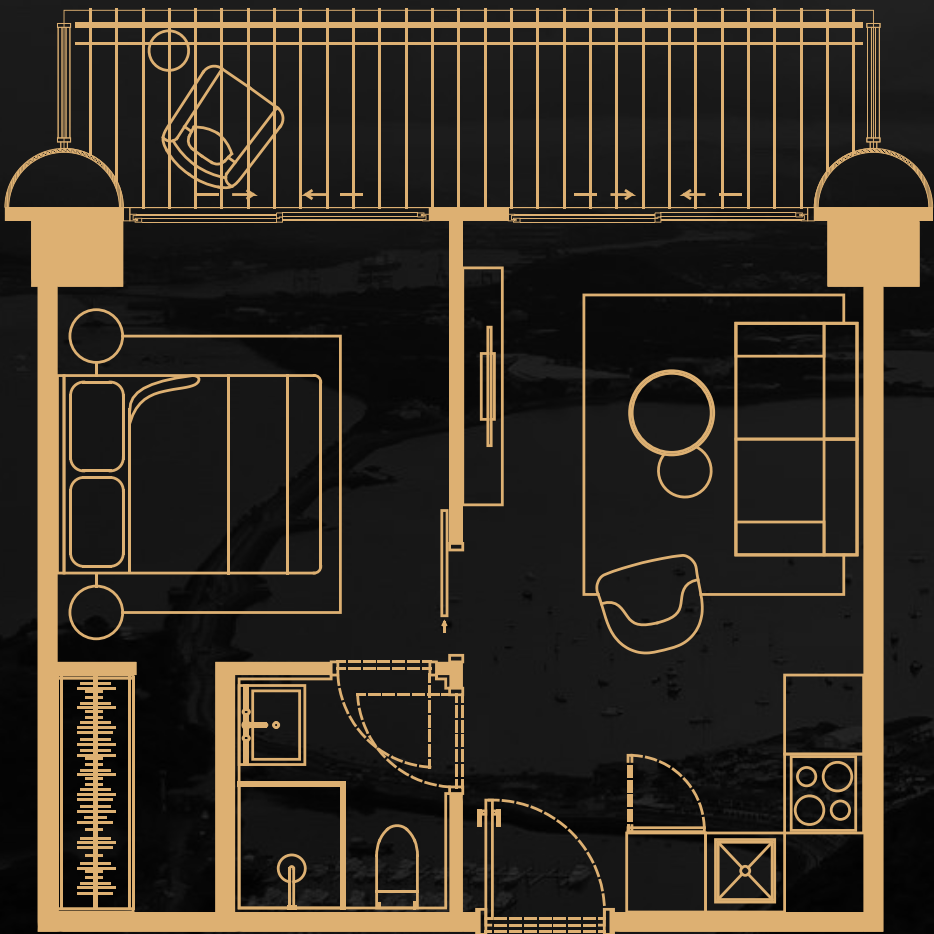

43.73m²
1 bedroom

LATERAL CANAL VIEW

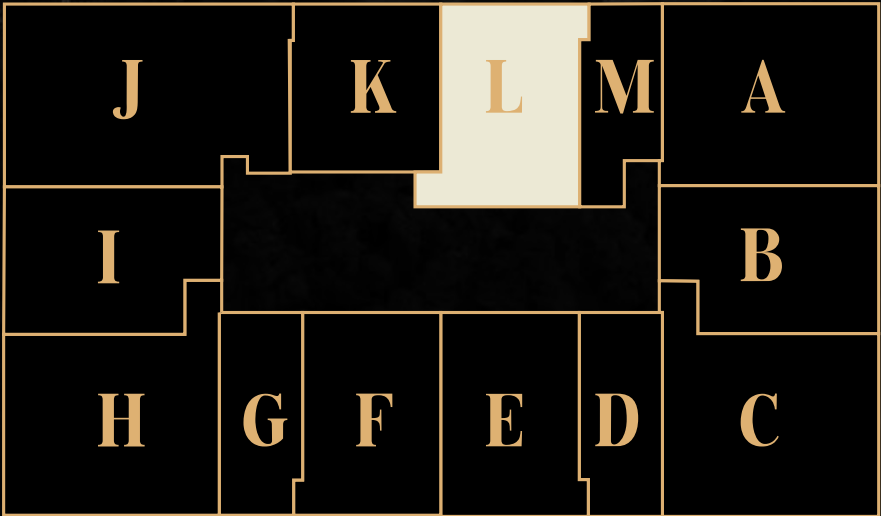

CITY/ OCEAN VIEW

CANAL VIEW

CANAL/ BRIDGE VIEW

1 BEDROOM RESIDENCE



MODEL L
51.26m²
1 bedroom

LATERAL CANAL VIEW

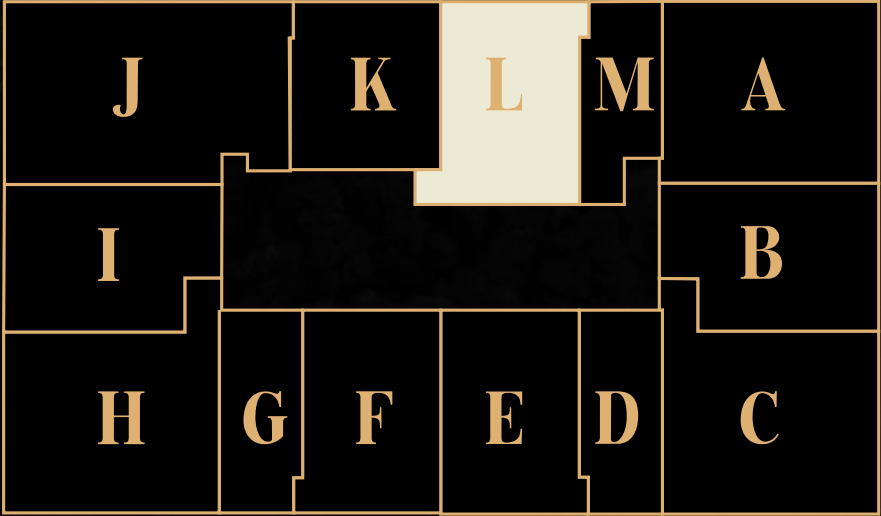

CITY/ OCEAN VIEW

CANAL VIEW

CANAL/ BRIDGE VIEW

STUDIO RESIDENCE

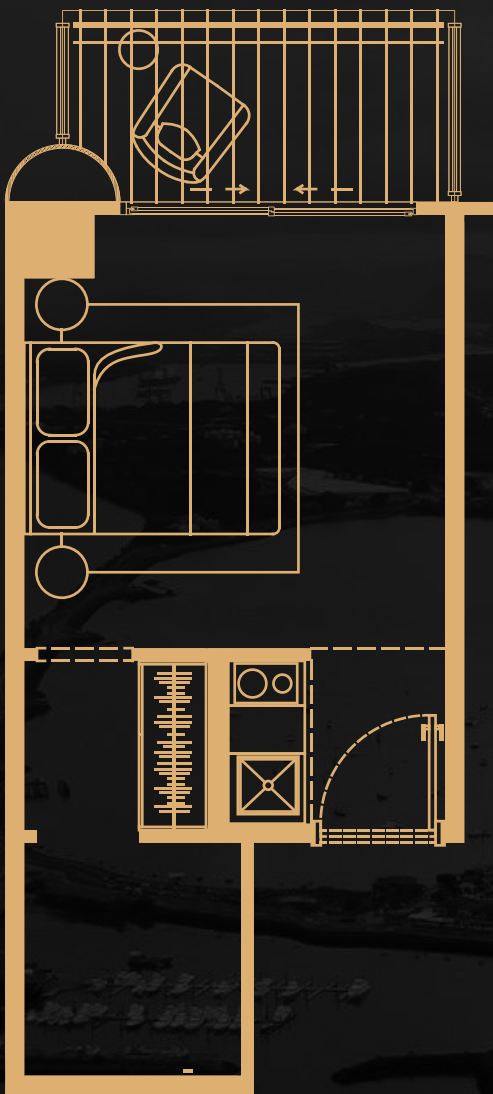

MODEL M
25.65m²
studio

LATERAL CANAL VIEW

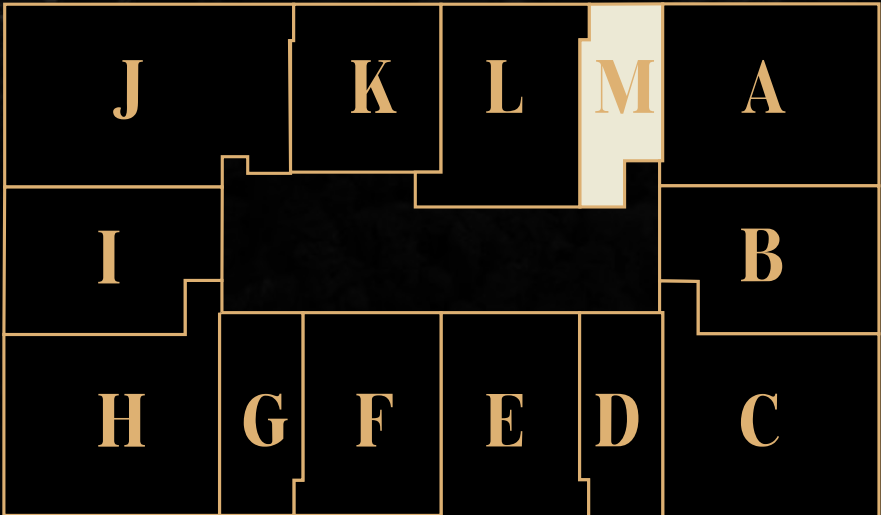

CITY/ OCEAN VIEW

CANAL VIEW

CANAL/ BRIDGE VIEW

1 BEDROOM RESIDENCE + LOCK OFF



MODELS C+D
100.68 m²
1 bedroom +
lock off studio

LATERAL CANAL VIEW

CITY/ OCEAN VIEW

CANAL VIEW

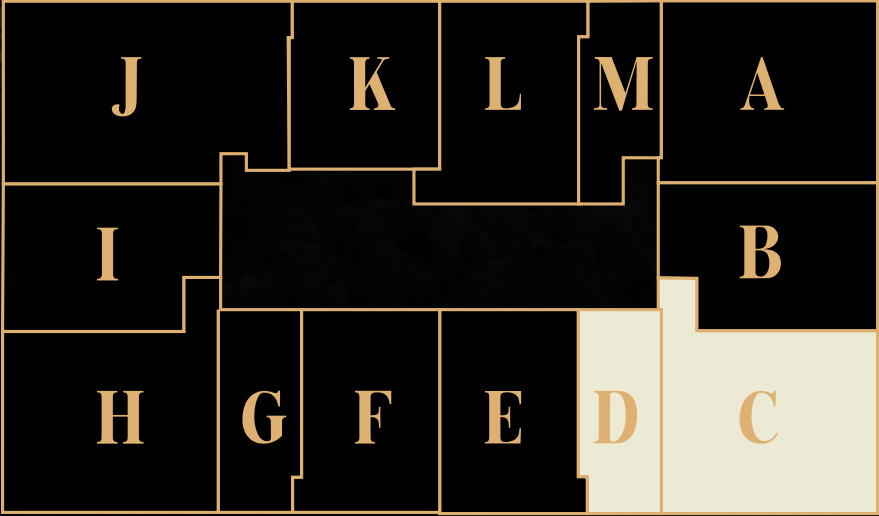

CANAL/ BRIDGE VIEW

1 BEDROOM RESIDENCE + LOCK OFF

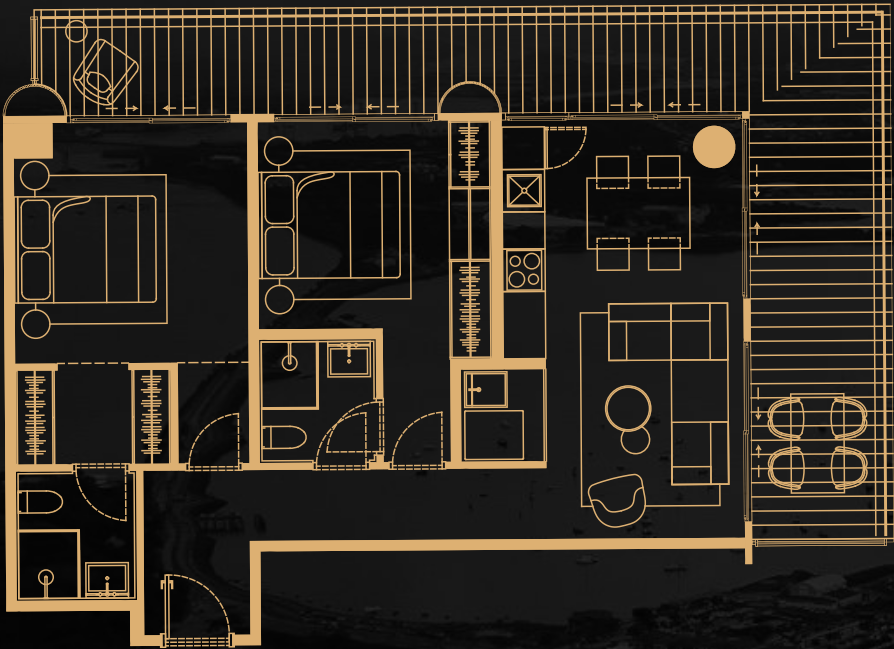

MODELS A+M

98.03m²

1 bedroom +
lock off studio

LATERAL CANAL VIEW

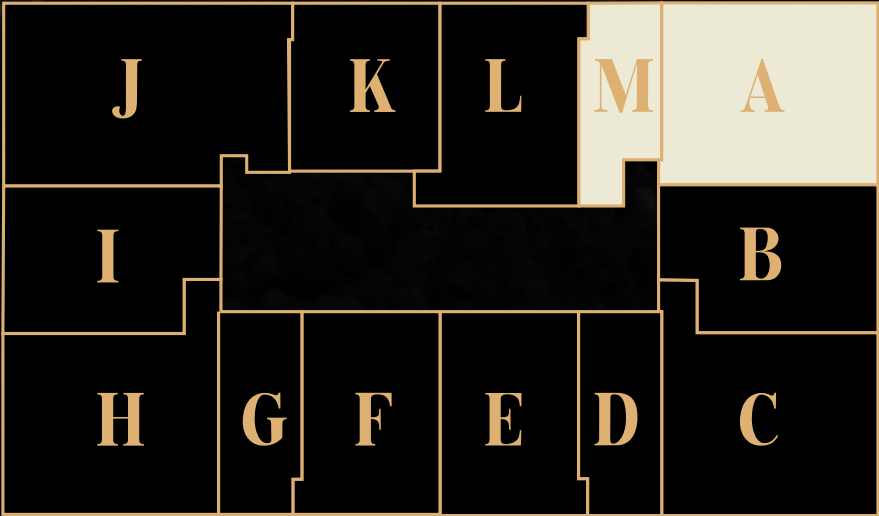

CITY/ OCEAN VIEW

CANAL VIEW

CANAL/ BRIDGE VIEW

RIGA

DEVELOPERS

Key City Ideas

Grupo Riga is a Panamanian company leading in the development, commercialization, and operation of real estate projects. For over 35 years since our founding, we have been committed to creating value through innovative housing solutions, with a focus on improving the quality of life in the communities where we operate.

At Grupo Riga, we take pride in contributing to the growth of the real estate sector while making a positive impact on the lives of Panamanian families. Each of our projects is an opportunity to transform lives, leaving a significant mark on the development of a more promising future. Our success is based on a team of highly qualified professionals who share our corporate values of respect, professionalism, and a genuine desire for excellence.



SHORT AND LONG TERM LUXURY RENTALS BY HOUSE HUNTERS PANAMA

Our main focus is to maximize the return on your investment. How do we achieve this? We fully manage rentals, offering a solution that keeps property owners always updated. We provide marketing services on various short- and long-term rental platforms. We focus on providing a warm and personalized experience to guests, with flexible bookings, high-speed internet, comfortable co-working spaces, and in-room amenities that make visitors feel at home.

Nautilus

AT THE PANAMA CANAL

DEVELOPED BY:

RIGA
DEVELOPERS
Key City Ideas

SALES BY:

H HOUSE
HUNTERS
PANAMA

T +507 6998-0016
Local S-10
PH The Ocean Club
Punta Pacífica
PANAMA CITY, PANAMA

nautiluspanamacanal.com
info@nautiluspanamacanal.com

*images for illustrative purposes